

# SupIR 13.6mm f/1.0, Fixed Athermalized 680412

TYPICAL ICD\*

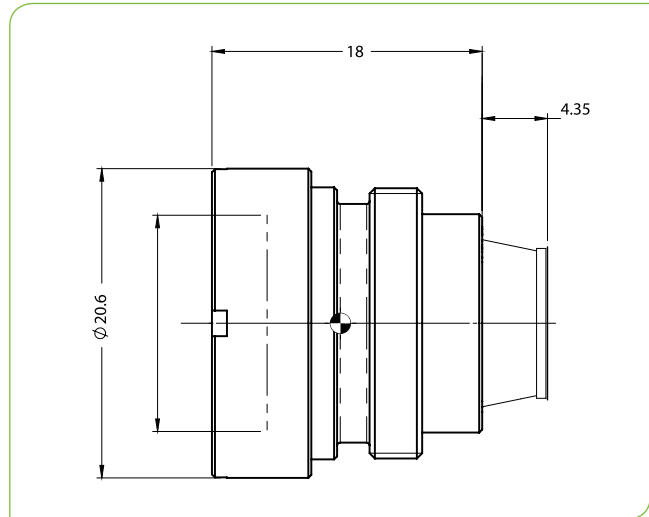

LWIR | 1-FOV

HFOV	320x240	384x288	640x480
17μ	22.8°	27.3°	
12μ	16.2°	19.3°	32.0°
10μ	13.5°	16.2°	26.8°

Property	Value				
<b>Optical</b>					
Focal Length	13.6mm				
F#	1.0				
Average transmission (8-12μm)	91% (HD) / 88% (LRHC)				
Back Focal Length	4.8mm in air				
<b>Mechanical</b>					
Focus Mechanism	Fixed				
Depth of Field	9m to infinity				
Focus Range	1m to infinity				
Weight	12.7gr				
Max. Dimensions	Ø20.6mm x 18mm				
<b>Environmental</b>					
Operation Temperature	-40°C to +80°C				
Storage Temperature	-50°C to +85°C				
Sealing	IP 67 front element only				
<b>Configurations</b>	<b>Weight (gr)</b>	<b>Dimensions</b>	<b>BWD**</b>	<b>Thread</b>	<b>Coating</b>
680412-003	12.7	Ø20.6mm x 18mm	4.35	M18x0.5	HD
680412-004					LRHC***

\* The ICD drawing provided here is primarily a representation and may not accurately reflect the product's actual dimensions and specifications. For precise integration specifications contact your local sales representative.

\*\* The BWD value is calculated for a unique detector setup with varying sealing windows in terms of thickness and material. For more details, contact your local sales representative.

\*\*\* For detailed LRHC coating specifications see page 16